

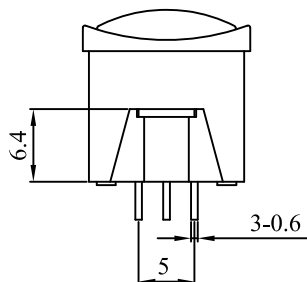

PB07

Rating: 0.1A 30V DC
 Contact Resistance: 100mΩ Max
 Insulation Resistance:DC 500V 100MΩ Min
 Dielectric Strength:AC 250V for 1 minute
 Total travel:1.5±0.3mm
 Operating Force:200±50gf
 Operating Life:50,000 cycles
 Operating Temperature:10°C~60°C
 Function:ON-OFF

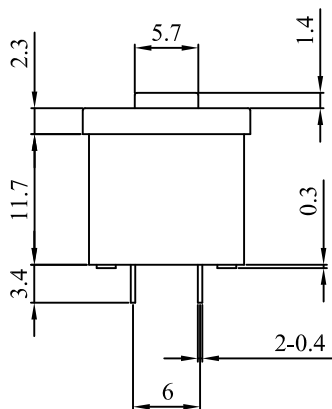
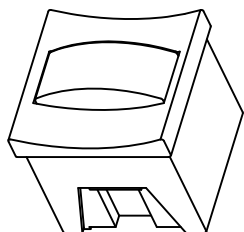
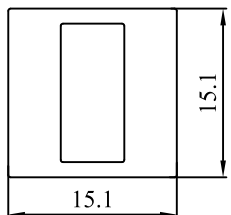

Contact Configuration:

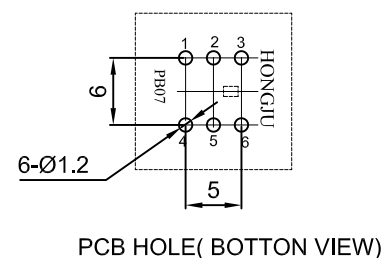
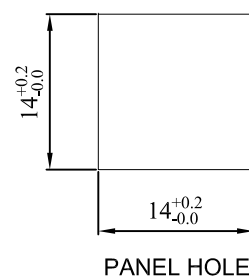
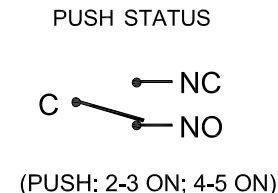
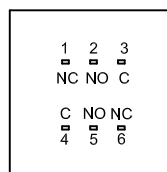
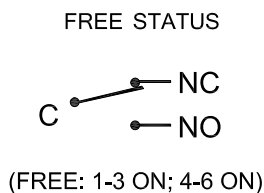

MATERIAL:

Outer Frame: ABS;
 Base: ABS;
 Actuator: ABS;
 Terminal:Brass,Silver or Tin plated.

Y	Yellow 黄色
W	White 白色
U	Blue 蓝色
R	Red 红色
O	Orange 橙色
G	Green 绿色
B	Black 黑色
A	Gray 灰色
CAP COLOR (X)	

				公差 TOLERANCES		.X± 0.3 .XX± 0.15		角度 ± 1°		单位 DIMENSION UNIT mm.	
				版本 VERSION	A1	比例尺 SCALE	NONE	日期 DATE	2020.08.27	品名 TITLE	图号 DRAWING NO
				核准 APPROVED BY		核对 CHECKED BY	Z. H. B.	绘图 DRAWN BY	HXG	PB07-GA-1N0	PB07-GA-1N0_A1
版本 VER.	变更说明 CHANGE DESCRIPTION	日期 DATE	ECN NO.	APPROVED BY		CHECKED BY	Z. H. B.	DRAWN BY	HXG	PB07-GA-1N0	PB07-GA-1N0_A1