

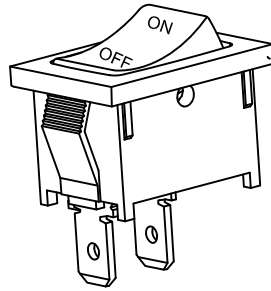

MR-1

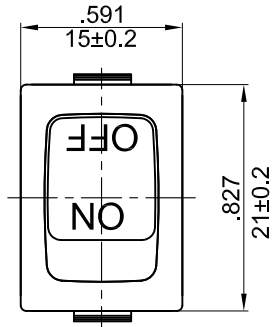

Rating: 10A 125V AC (UL CUL)
 6A 250V AC (UL CUL VDE CB)
 Contact Resistance: 50mΩ Max
 Insulation Resistance: DC 500V 100MΩ Min
 Dielectric Strength: AC1500V 1 minute
 Electrical life: 10,000 cycles
 Operating Temperature: 0°C ~85°C

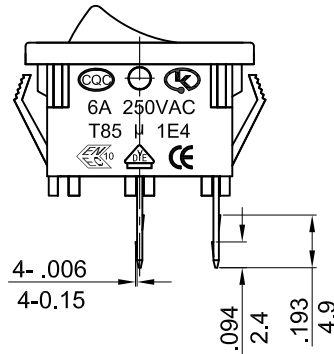
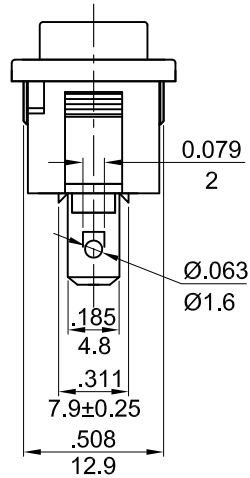
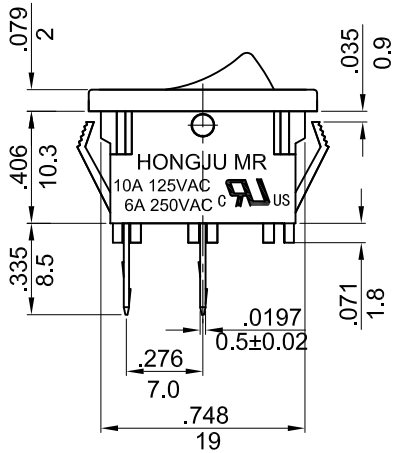

CUT-OUT

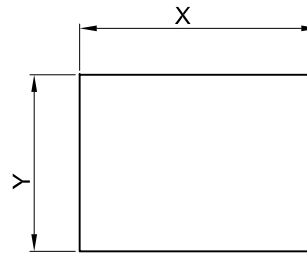

	X	Y
0.75~1.25	19.2 ^{+0.1} _{-0.0}	12.9 ^{+0.15} _{-0.00}
1.25~2.00	19.4 ^{+0.1} _{-0.0}	12.9 ^{+0.15} _{-0.00}
2.00~3.00	19.8 ^{+0.1} _{-0.0}	12.9 ^{+0.15} _{-0.00}

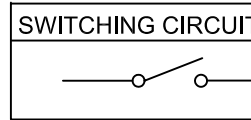

MATERIAL:

Body:Nylon66,UL rated:94V-2 min
 Actuator:Nylon66,UL rated:94V-2 min
 Terminal:Brass,silver or tin plated

X	0	1	2	3	4	5	7	8	9	A	B	C	D	E	G
Marking	none	•	ON OFF	≡	—	○	○	ON/开 OFF/关	⚡	💡	⊖	⊖	⊖	⊖	⊖

			公差 TOLERANCES		.X±0.3 .XX±0.15		角度 ANGLE ±1°		单位 DIMENSION UNIT mm.			
			版本 VERSION	A1	比例尺 SCALE	NONE	日期 DATE	2020.07.17	品名 TITLE		图号 DRAWING NO	
A1			重新整理后发行	2020.07.17	N/A	核准	核对	绘图	MR-1-119-C2N-WWAAE		MR-1-119-C2N-WWAAE_A1	
版本 VER.	变更说明 CHANGE DESCRIPTION	日期 DATE	ECN NO.	APPROVED BY	CHECKED BY	DRAWN BY						